

ECHO ROUND

1.5W MINI LED STEP LIGHT

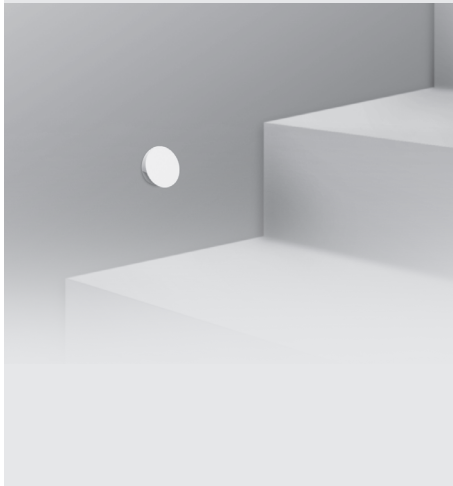

FIXTURE
COLOUR OPTIONS



Silver
Anodized



Matt Black

- Compact, Recessed, stylish construction
- >24 lm/W module
- Colour rendering index: 85
- Colour temperature options: 2700K, 3000K, 4000K
- Beam pattern options: 40°
- Uniform and comfort light
- Ø32mm cutout
- IP67

AVAILABLE OPTIONS

DRIVER



(24V)

TEMPERATURE



BEAM ANGLE

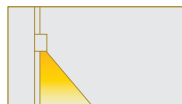

40°

DIMENSIONS (MM)

**Displayed height measurements are for highest point of fitting.*

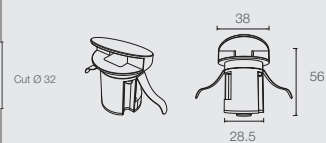

SYSTEM SPECIFICATIONS

| LED Lamp Power | Colour | Beam Angle | STANDARD CRI 85 | |
|----------------|---|------------|-----------------|---------------|
| | | | Intensity (cd) | Luminous Flux |
| 1.5W | WARM : 2700K WARM : 3000K NATURAL : 4000K | 40° | 11 | 36 |

Data are based on 3000K. Nominal data of 2700K and 3500K are shared with 3000K. Higher CCT of 4000K and 5000K will have a nominal data value of 5% higher than published. the table information is at nominal values accuracy of +/-7% nominal CRI >85, equal to Ra >80-87, R9 > 0 nominal CRI <85, equal to Ra >90-97, R9 > 50

DETAILS SPECIFICATION

| | |
|----------------------------|---|
| Family Type | Echo Series |
| Mains voltage | 24V DC |
| Colour options | Silver Anodized, Matt Black |
| Installation Compatibility | Echo Round |
| Lifetime | 50,000 HOURS (80% lumen maintenance at Ta = 25°C) |
| Mains connection | Screw terminal connection |
| Materials | Aluminum 6063-T5 |
| IP code | IP67 |
| Safety class | Class 3 |
| Weight | 0.05kgs |
| Dimensions | Ø38 x 56mm |
| Warranty | 3 Years |

| FIXTURE | | LED MODULE | | | |
|-------------------|-----------------|---------------|---------------|-----------------|----------|
| Type | Colour | LED Power | Beam Angle | Colour Temp | CRI |
| ECHO-ROUND | — | — | — | — | — |
| SA | Silver Anodized | 1 1.5W | 40 40° | 27 2700K | Standard |
| MB | Matt Black | | | 30 3000K | |
| | | | | 40 4000K | |

example: ECHO-ROUND.SA.1.40.27